

Z-access Site Map

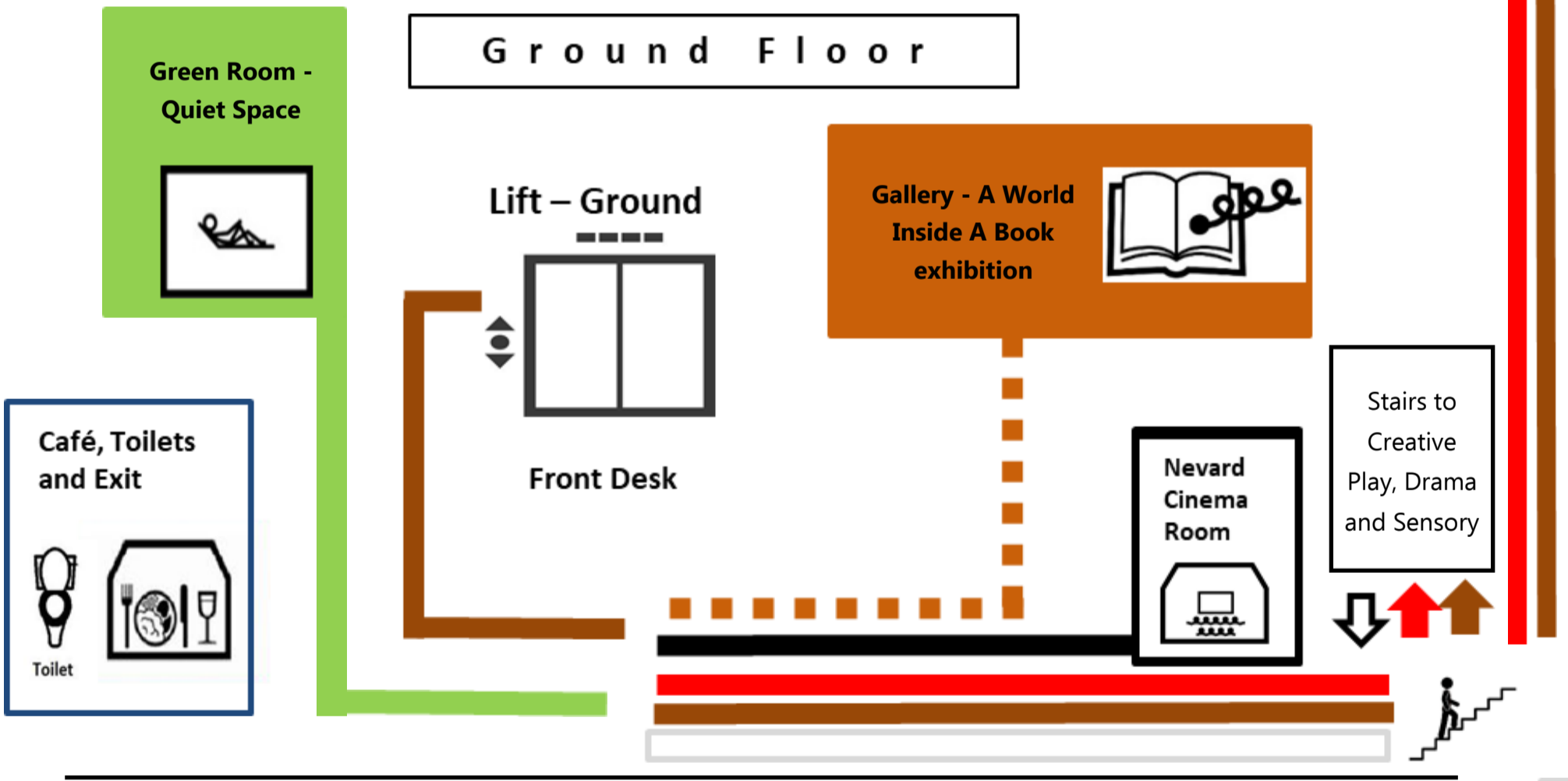

Lower Ground Floor

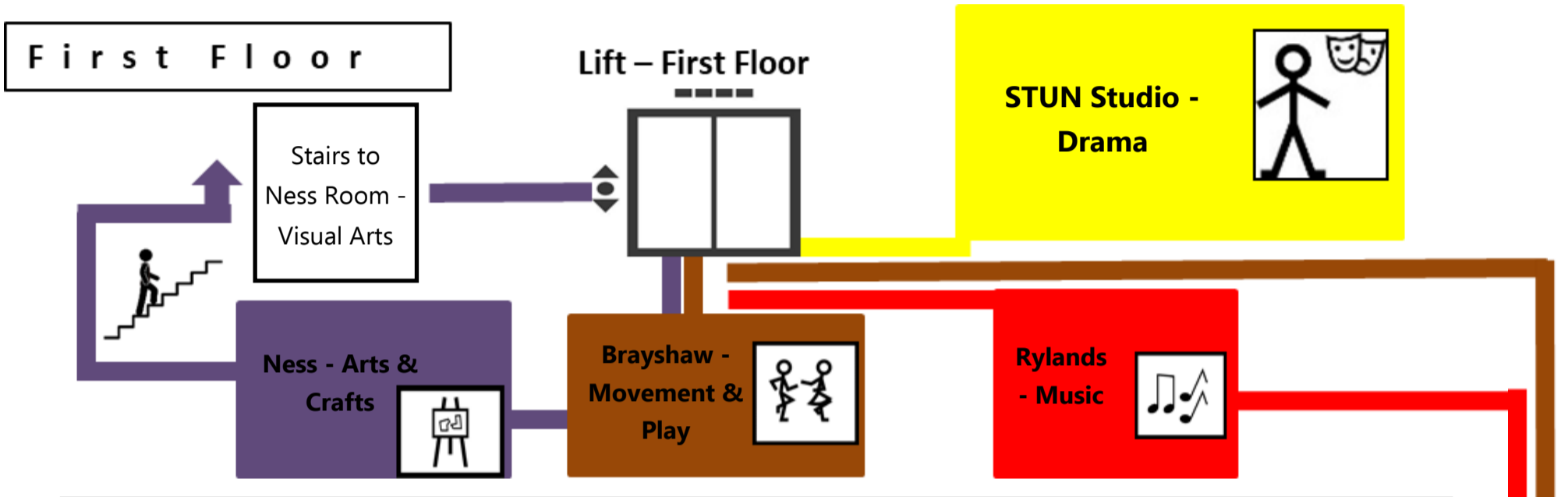
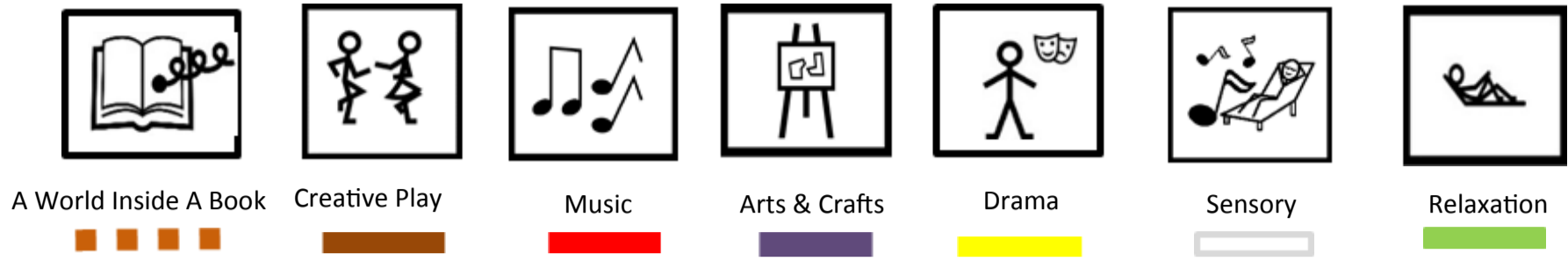
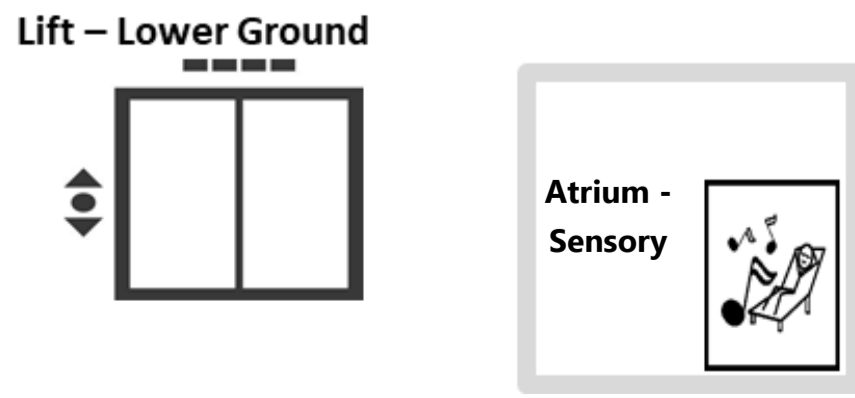

Green Room - Quiet Space

An open space throughout the day

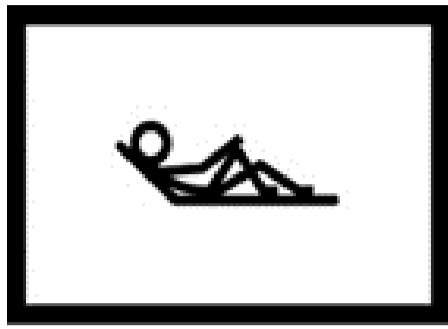

The Green Room is an open space if you would like to take time out and relax from any of the day's activities.

Ness - Arts & Crafts

Janine & Kirsty

10am - 2pm



Join Janine & Kirsty for some arts and crafts!

STUN - Drama

Ged

10am - 2pm



Drop in for Drama with Ged! Learn new drama skills while having fun!

Rylands - Music

Sarah

10am - 2pm



Discover a world of music and fun instruments, from piano and bells to funky drums and shakers

Atrium - Sensory Space

Open all session

10am-2pm



A place to relax in our igloo.

Brayshaw Room - Creative Play

Edenamiuki

10am - 2pm

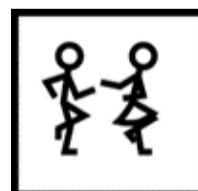

Join Eddie to move and dance around in this creative play session.